

LEGEND

- COUNTY ROADS
- TOWNSHIP ROADS
- STATE ROADS
- ALLOTMENT ROADS
- TOWNSHIP LINE
- COUNTY LINE
- CORPORATION LINE
- PRIVATE ROADS
- AREA WITHIN A CORPORATION

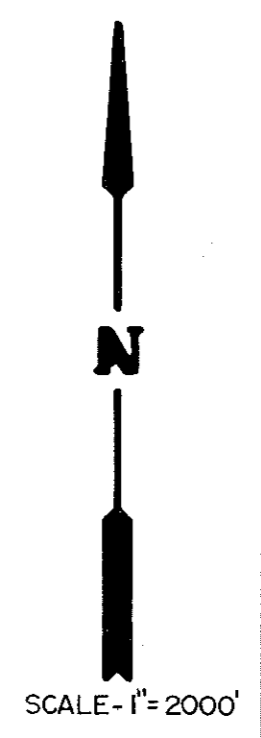

ROAD INDEX CONTINUED

ROAD NAME	ROAD NO.	LOT NO.
WATERLOO	87	33
WEAKLAND	115	42
WHITEHALL DR.	T.H. 1936	13
WILLOWOOD DR.	1951	23
WINGFOOT	6	29
WINTERHAVEN DR.	1955	18
WITSAMAN DR.	403	23
WOODBRIAR DR.	407	48
WOODHAVEN DR.	T.H. 1983	48
WOODLARK DR.	1974	14
WOODSDALE DR.	411	50

HOUSE NUMBER GUIDE

To locate the approximate location of a house number, connect any two corresponding north or east numbers within the map border with a straight edge and intersect with the desired road.

Even numbers are on the south side of an east/west road, and the east side of a north/south road.

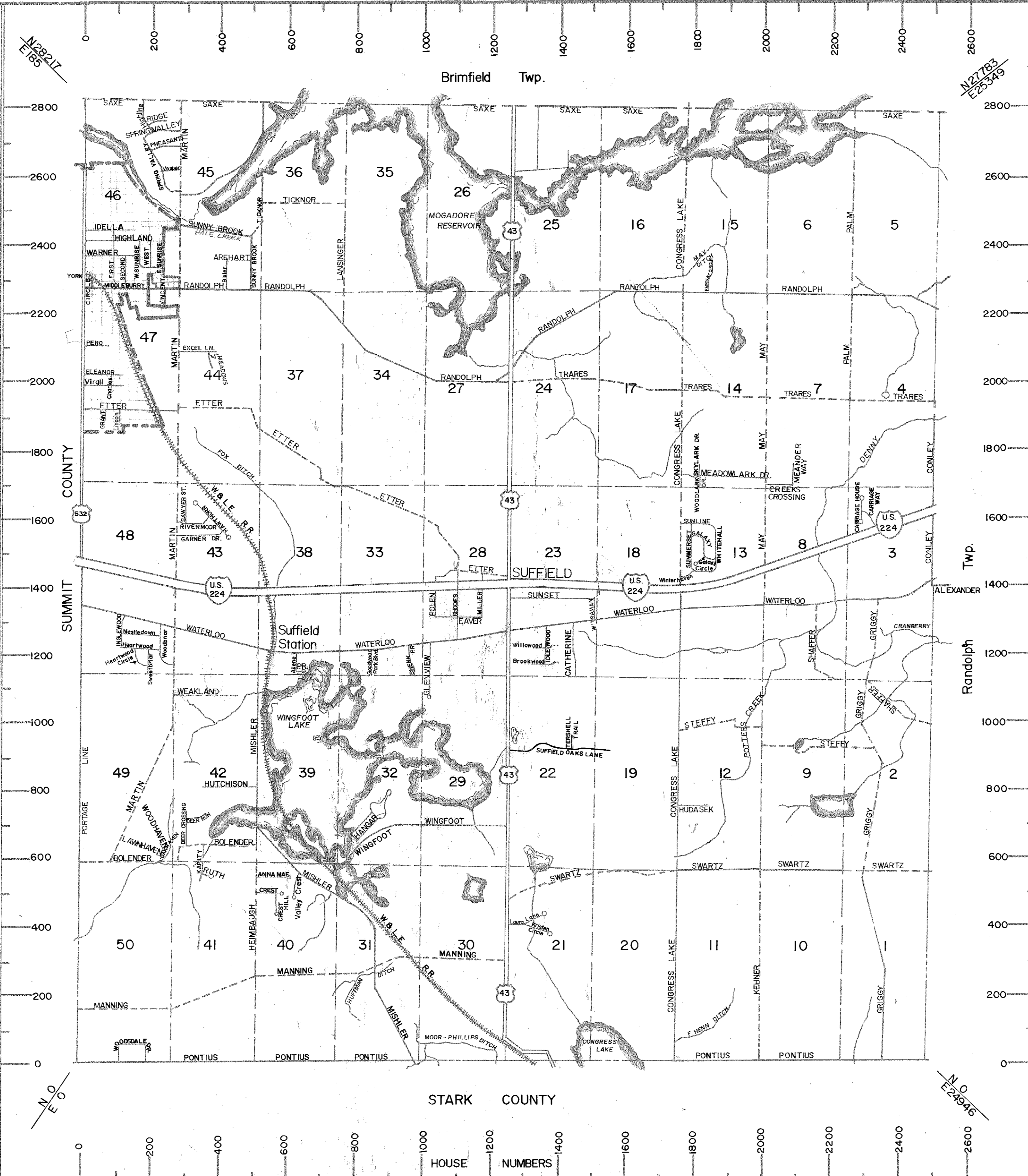

STATE ROAD NAME - ROAD NO. - HWY NO.

CLEVELAND-CANTON	43	460
AKRON-CANFIELD	224	87
CUYAHOGA FALLS-MOGADORE	532	722

**R
O
A
D

I
N
D
E
X**

ROAD NAME	ROAD NO.	LOT NO.
AILENE DR.	PR. 1961	38
ALEXANDER	27	3
ANNA MAE DR.	1953	40
AREHART DR.	413	45
BIXLER DR.	412	45
BOLENDER	5	49
BROOKWOOD DR.	1952	23
CARRIAGE HOUSE DR.		3
CARRIAGE WAY		3
CATHERINE ST.	410	23
CONGRESS LAKE	17	20
CONLEY	26	4
CREST DR.	1954	40
CREST HILL DR.	1964	40
CREEKS CROSSING TRAIL		47
EAVER ST.	400	28
ETTER	9	44
FILTER CIRCLE		15
GALAXY CIRCLE	TH. 1959	13
GALAXY DR.	TH. 1958	13
GARNER DR.	TH. 1975	43
GLENVIEW DR.	417	28
GOODYEAR PARK BLVD.	TH. 1971	33
GRIGGY	20	45
HAWTHORN ST.	TH. 1976	43
HEARTWOOD CIRCLE	418	48
HEARTWOOD DR.	408	48
HEIMBAUGH	3	41
HIGHLINE DR.	1965	46
HUTCHISON DR.	1968	42
HUDASEK DR.	FR. 1969	12
IDLEWOOD DR.	1950	23
INGLEWOOD DR.	416	48
KAPITY DR.	1977	42
KEHNER	19	11
KRISTEN CIRCLE		21
LANSINGER	13	36
LAURA LANE		21
LAWNHAVEN DR.	T.H. 1982	49
MEANDER WAY		7
MANNING	2	50
MARTIN	2	49
MAY	23	14
MEADOWLARK DR.	1972	14
MILLER AVE.	401	28
MISHLER	4	31
NESTLEDOWN DR.	409	28
OAKHAVEN DR.	T.H. 1981	49
PALM	24	6
PHEASANT DR.	419	46
POLEN AVE.	404	41
PONTIUS	42	10
PONTIUS	42	49
PORTAGE LINE		7
RANDOLPH	10	16
RHODES AVE.	405	28
RIVERMOOR DR.	1966	43
RUTH CIRCLE	1978	41
SAWYER ST.	79	43
SAXE	21	5
SHAFFER	21	2
SHENK	PR. 1963	33
SKYARK DR.	1973	14
SPRING VALLEY BLVD.	412	46
STEEFY	42	12
SUMMERSET DR.	TH. 1957	13
SUNLINE DR.	TH. 1960	11
SUNNY BROOK	11	46
SUNSET DR.	402	23
SWARTZ	16	39
SWEET BRIAR DR.	1962	48
TERSHELL TRAIL		22
TICKNOR	14	36
TRARES	14	25
VALLEY CREST	1967	40
VESPER DR.	415	46
VINCENT ST.	406	47
* SUFFIELD OAKS LANE		19 & 22
EXCEL LN.		44
MEADOWS DR.		44
DEER CROSSING RD.		42
DEER RUN CIRCLE		42

SUFFIELD TOWNSHIP

PORTAGE COUNTY OHIO

MICHAEL A. MAROZZI P.E., P.S.
PORTAGE COUNTY ENGINEER

ALLOTMENT	LOT	PG
AREHART	45	45A
BRADSHAW'S 1ST. ADDITION		
BRIARWOOD VILLAGE ALLOTMENT 1,2,3	48	48A
BRIARWOOD VILLAGE ALLOTMENT 4,5	43	43
BROOKHILL ALLOTMENT	49	49
BROOKHILL ESTATES	42 & 49	49
CARRIAGE HOUSE ESTATES	3	3
CENTRAL ALLOTMENT	46	46A
CHESTNUT HIGHLANDS SUBDIVISION	11	11
COFFEY ESTATES	2 & 9	2
CONGRESS LAKE HEIGHTS SUBDIVISION 1 & 2	14	14
CONLEY SUBDIVISION	42	42
CREEKS CROSSING	23	23B
ECHO HILLS ALLOTMENT	7	7
FAIRWAY ESTATES SUBDIVISION	15	15
FAIRLANE ESTATES ALLOTMENT (and RESUBDIVISION OF SL. 1-5 & 10-11)	13	13A
FOLEY, H.W. SUBDIVISION	16	16
DEER CROSSING ESTATES	42	42
GOLF-VIEW SUBDIVISION	46	46
HOLLAND HEIGHTS SUBDIVISION & REPLAT	24	24
HUTCHISON SUBDIVISION	8	8

ALLOTMENT	LOT	PG
JOE DEMBOSKI SUBDIVISION	7	7
JUL-EM ACRES	12	12
LAKEVIEW CREST ALLOTMENT 2,3,4,5	40	40N
LAKEVIEW ESTATES ALLOTMENT SLS. 1-12, 16-21	29	29
	29	29
	15	15
LENTZ ACRES	47	47A
LUTZ, SIMON ALLOTMENT	47	47A
MEADOWS OF MOGADORE	47	47A
MARY-JO SUBDIVISION	10	10
MAY ROAD SUBDIVISION	13	13
MCALPINE HEIGHTS ALLOTMENT & NO. 2	47	47B
OAKS OF SUFFIELD	41 & 42	41N
OAK KNOLLS ACRES	47	47B
ORCHOLM ALLOTMENT & NO. 2	47	47B
PERO ALLOTMENT	47	47B
POLEN ESTATES	28	28
PONTIUS ROAD ALLOTMENT & REALLOT. SLS. 1-22	50	50A
RIVERMOOR ESTATES (PART II)	43	43
ROTHERMEL, JOSEPH ADDITION	3	3
RUSTIC HILLS SUBDIVISION	45	45

ALLOTMENT	LOT	PG
SHARON PARK ESTATES	33	33
SHENK ESTATES	33	33
SIMON LUTZ ALLOTMENT	47	47A
SPRING VALLEY & NO. 2, NO. 3	46	46D
SUFFIELD HEIGHTS	28	28A
SUFFIELD HOMESITES	23	23A
SUNRISE ALLOTMENT	46	46C
SUZANNE'S PLANTATION ACRES	21	21
SWAN LAKE ESTATES	50	50
SWINEHART'S 2ND ADDITION	23	23B
SUFFIELD PROPERTIES SUBDIVISION	10	10
WARNER'S ADDITION	46	46A
WILD CHERRY HILL ALLOTMENT	46	46A
WINGFOOT ACRES ALLOTMENT	42	42
WILSON-MAY ALLOTMENT	23	23B
WISPERING MEADOWS SUBDIVISION	44	44
WYNSTONE	46	46-E

HOUSE NUMBERS