

LEGEND

- COUNTY ROADS
- TOWNSHIP ROADS
- STATE ROADS
- ALLOTMENT ROADS
- TOWNSHIP LINE
- COUNTY LINE
- RAILROADS

SCALE: 1" = 2000'

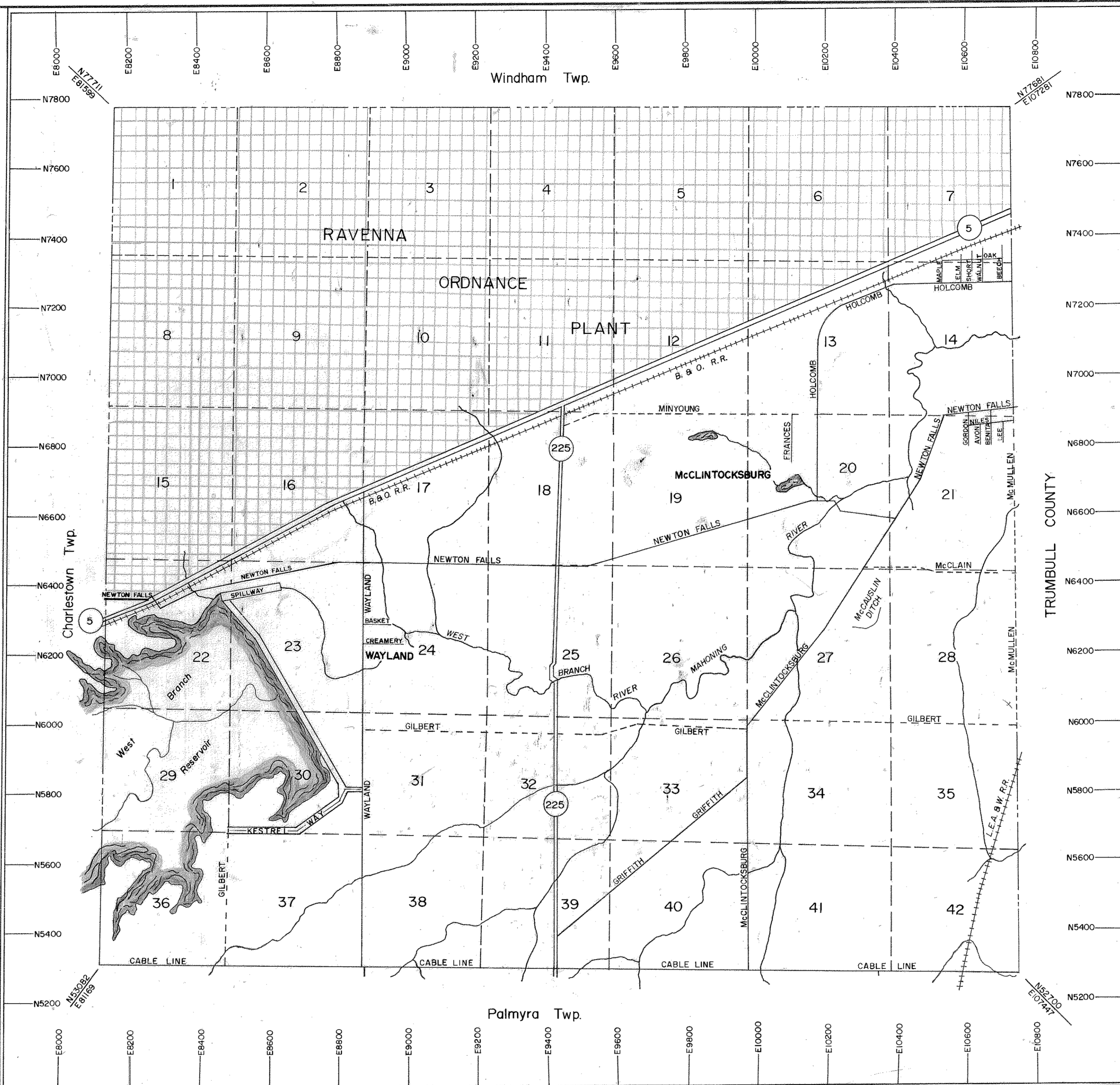

STATE ROAD NAME - ROAD NO. - HWY. NO.

RAVENNA - WARREN	5	322
ALLIANCE - PARIS	225	76

**R
O
A
D

I
N
D
E
X**

ROAD NAME	ROAD NO.	LOT NO.
AVON AVE.	617	21
BASKET ST.	621	24
BEECH ST.	615	14
BENITA AVE.	618	21
CABLE LINE	120	42
CREAMERY ST.	622	24
ELM ST.	612	14
FRANCES RD.	637	20
GEORGE	181	23
GILBERT	188	33
GORDON AVE.	616	21
GRIFFITH	191	33
HOLCOMB	187	14
KESTREL WAY (ACCESS ROAD)		30
LEE AVE.	619	21
MAPLE ST.	610	14
McCLINTOCKSBURG	135	20
McLAIN	192	28
McMULLEN	194	28
MINYOUNG	185	13
NEWTON FALLS	177	21
NILES AVE.	620	21
OAK ST.	611	7
SHORT ST.	613	14
WALNUT ST.	614	14
WAYLAND	132	37

HOUSE NUMBER GUIDE

To locate the approximate location of a house number, connect any two corresponding north or east numbers within the map border with a straight edge and intersect with the desired road.

Even numbers are on the south side of an east/west road, and the east side of a north/south road.

**A
L
L
O
T
M
E
N
T**

**I
N
D
E
X**

ALLOTMENT	LOT NO.	PAGE NO.
CHRIS KAINRAD ACRES	16 & 23	16
HICKORY KNOLLS	16 & 23	23A
J.F. MORRISON PLAT NO. 1	28	28
LA BELLE HEIGHTS	14 & 21	21A
LEISURE ACRES	39	39
LEISURE LAKE SUBDIVISION	38 & 39	38 & 39
McCLINTOCKSBURG HARRISPORT	20 & 21	20A
MINYOUNG ROAD ESTATES	13	13
MINYOUNG ROAD ESTATES NO. 2	12 & 13	12 & 13
NEWTON REALTY & CONSTRUCTION CO.	7 & 14	14A & B
PARADISE ACRES PLAT NO. 1	40	40
SARI	25	25
SHEARER ESTATES & PLAT 2	18	18
SUNSHINE SPRING LAKE NO. 1	20	20B
WAYLAND NEWPORT	23 & 24	24A
WEST BRANCH HEIGHTS	32	32

**PARIS
TOWNSHIP**

**PORTAGE COUNTY
OHIO**

MICHAEL A. MAROZZI P.E., P.S.
PORTAGE COUNTY ENGINEER