

LEGEND

- COUNTY ROADS
- TOWNSHIP ROADS
- STATE ROADS
- ROADS WITHIN CORPORATION
- ALLOTMENT ROADS
- CORPORATION LINE
- TOWNSHIP LINE
- COUNTY LINE
- AREA WITHIN A CORPORATION

N

SCALE: 1" = 2000'

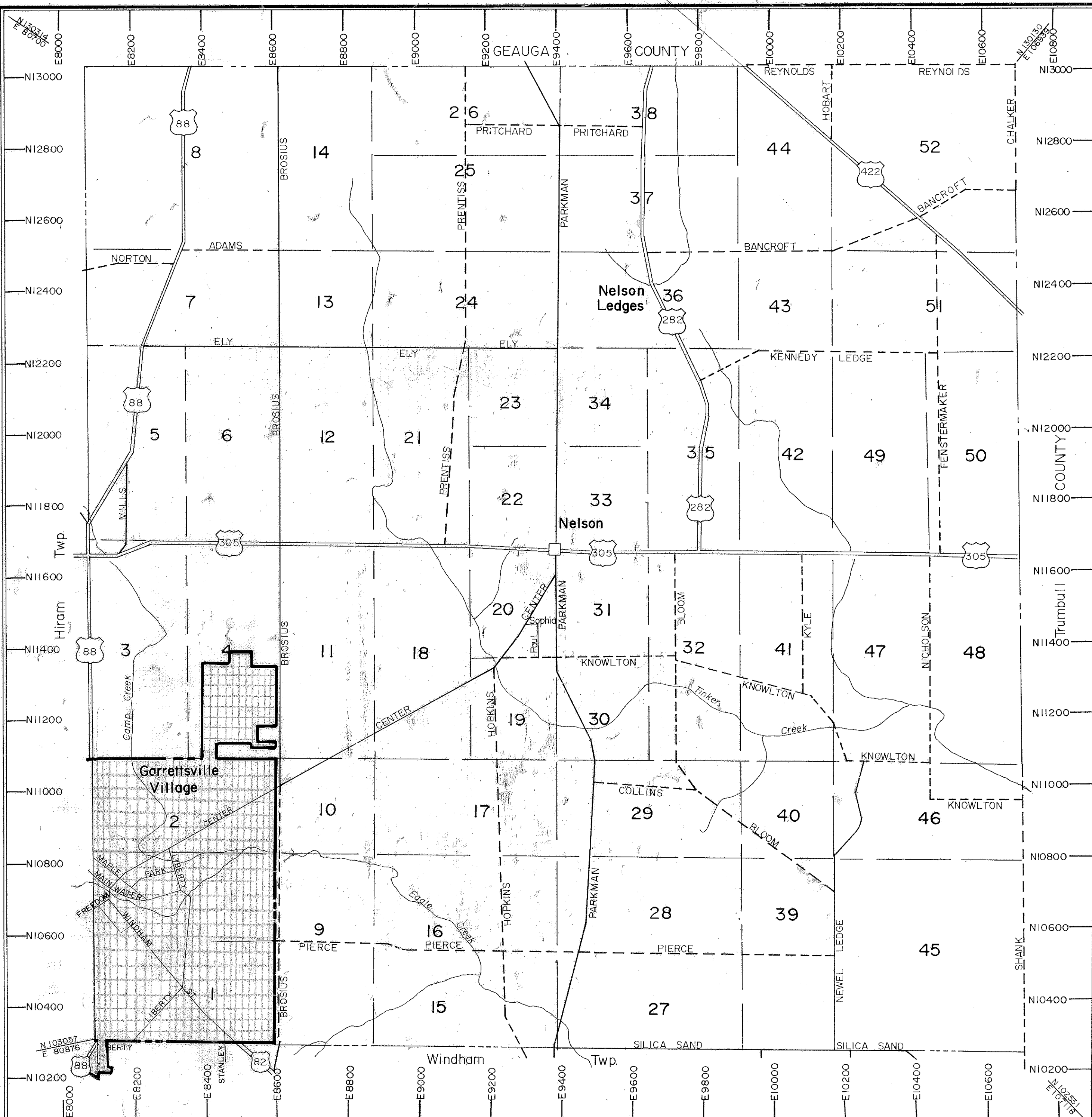

STATE ROAD NAME ROAD NO. HWY. NO.

RAVENNA-PARKMAN	88	326
GARRETTSVILLE-PARKMAN	282	585
HIRAM-SOUTHINGTON-HARTFORD	305	649
WARREN-BURTON	422	325

ROAD INDEX

ROAD NAME	ROAD NO.	LOT NO.
ADAMS	282	8
BANCROFT	304	37
BLOOM	296	40
BROSIUS	289	6
CENTER	293	11
CHALKER	305	52
COLLINS	294	29
ELY	288	6
FENSTERMAKER	307	50
HOBART	302	44
HOPKINS	250	19
KENNEDY LEDGE	306	49
KNOWLTON	295	30
KYLE	311	41
MILLS	291	5
MUMFORD	286	5
NEWEL LEDGE	297	46
NICHOLSON	298	47
NORTON	280	7
PARKMAN	299	28
PAUL ST.	927	20
PIERCE	292	28
PRENTISS	290	25
PRITCHARD	300	26
REYNOLDS	303	52
SHANK	308	45
SILICA SAND	253	27
SOPHIA ST.	926	20

HOUSE NUMBER GUIDE

To locate the approximate location of a house number, connect any two corresponding north or east numbers within the map border with a straight edge and intersect with the desired road.

Even numbers are on the south side of an east/west road, and the east side of a north/south road.

ALLOTMENT

INDEX

ALLOTMENT	LOT	PAGE
COLLIER ALLOTMENT	41	41N
COLVIN ESTATES	39	39
EAGLE CREEK ESTATES	10,11	10 SUB LOTS 1-8, 11 SUB LOTS 9-13
HILLTOP ESTATES	52	52S
KYLE ALLOTMENT	41	41S
MILLS PARK	5	5A
NELSON TRIANGLE PARK	20	20A
WADSWORTH ACRES	5	5A
WOODVIEW COLONIES	16	16
WOODVIEW COLONIES PHASE 2	15	15

NELSON TOWNSHIP

PORTAGE COUNTY
OHIO

MICHAEL A. MAROZZI P.E., P.S.
PORTAGE COUNTY ENGINEER