

LEGEND

- COUNTY ROADS
- TOWNSHIP ROADS
- STATE ROADS
- ALLOTMENT ROADS
- TOWNSHIP LINE
- LOT LINE
- SUBDIVISION LINE
- RAILROADS

SCALE: 1" = 2000'

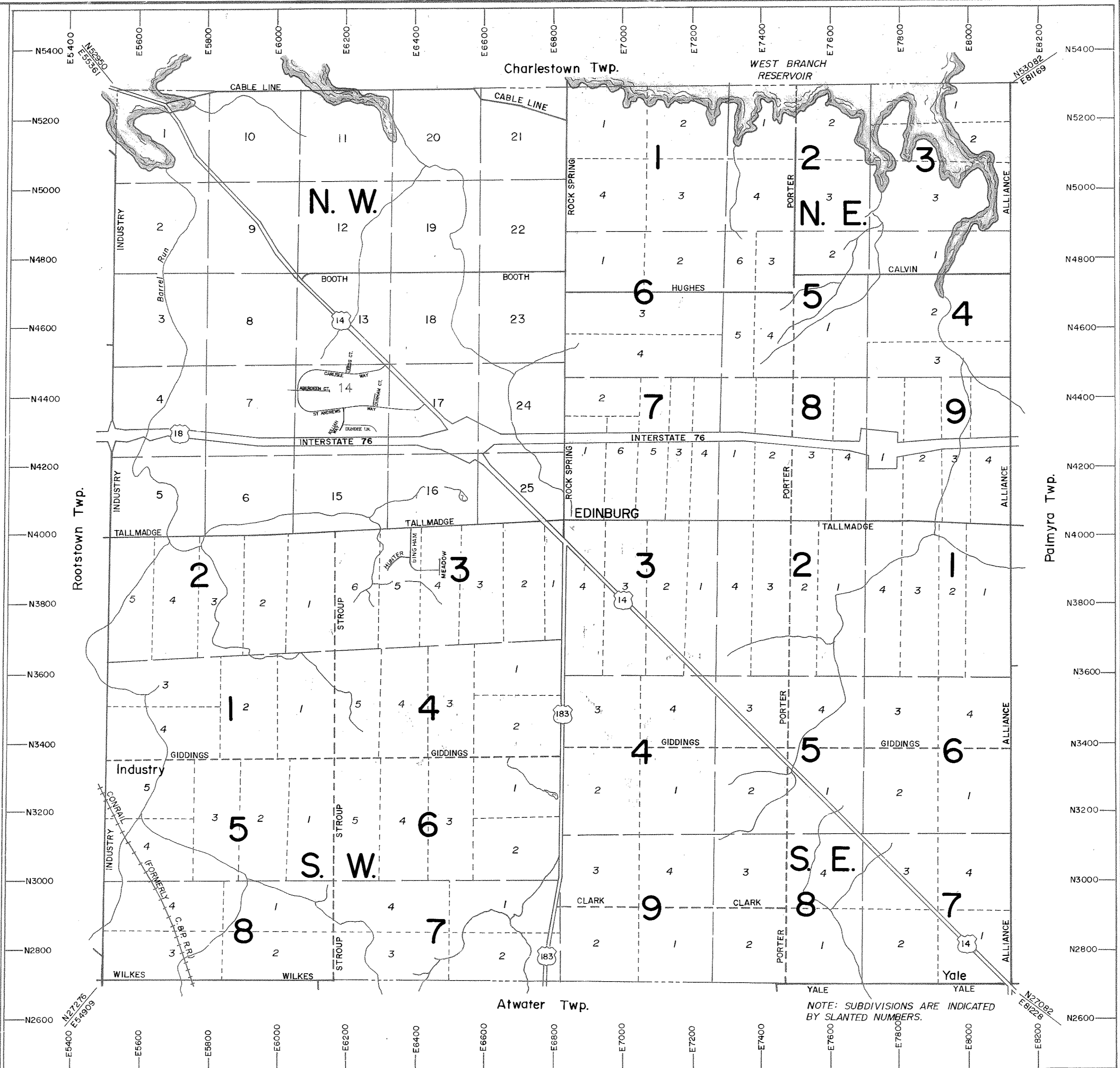

STATE ROAD NAME	ROAD NO.	HGWY. NO.
CLEVELAND-E. LIVERPOOL	14	12
EDINBURG-ALLIANCE	183	514
INTERSTATE	76	

ROAD NAME	ROAD NO.	LOT NO.
ABERDEEN CT.	125	17 N.W. 7.S.E.
BINGHAM PLACE BOOTH	119	3 S.W. 13 N.W.
CARLISLE WAY		14 N.W. 21 N.W.
CABLE LINE	120	4 N.E. 4 N.E.
CALVIN	124	9 S.E. 14 N.W.
CLARK	121	4 S.E. 3 S.W.
DURHAM CT.	117	6 N.E. 14 N.W.
GIDDINGS	122	2 N.W. 14 N.W.
HUNTER PLACE	47	14 N.W. 5 S.E.
HUGHES	54	7 N.E. 14 N.W.
LEEDS CT.	52	14 N.W. 6 S.W.
INDUSTRY	50	16 N.W. 8 S.W.
KILLIAN CT.	18	16 N.W. 8 S.W.
PORTER	116	8 S.W. 8 S.E.
ROCK SPRING	55	14 N.W. 3 S.W.
ST. ANDREW'S WAY		
STROUP		
TALLMADGE		
WILKES		
YALE		

ROAD INDEX

HOUSE NUMBER GUIDE

To locate the approximate location of a house number, connect any two corresponding north or east numbers within the map border with a straight edge and intersect with the desired road.

Even numbers are on the south side of an east/west road, and the east side of a north/south road.

ALLOTMENT INDEX	ALLOTMENT	LOT NO.	PAGE NO.
	ALAN ACRES	8 S.E. DIV. 4	8 S.E.
BINGHAM PLACE	3 S.W. DIV. 45, 6	3 S.W.	
BARREL RUN SUBD.	2 N.W. & 9 N.W.	2 & 9 N.W.	
BLUEBIRD MEADOWS SUBDIVISION	6 S.E. DIV. 4	6 S.E. DIV. 4	
DUNLAVY	7 N.E. DIV. 1	7 N.E.	
HIGHLANDS OF EDINBURG	7, 13, 14, & 17 N.W.	17 N.W.-A	
HLUCH SUBD.	7 S.W. & 9 S.E.	9 A S.E.	
MARLENE MEADOWS	2 S.W. DIV. 1	2 S.W. S.D. 1	
ROCK SPRING HEIGHTS	22 N.W.	22 N.W.	
WOODLAND ACRES	6 S.W. S.D. 1	6 S.W. S.D. 1	
YALE ACRES	7 S.E. S.D. 1	7 S.E. S.D. 1	

EDINBURG TOWNSHIP

PORTAGE COUNTY OHIO

MICHAEL A. MAROZZI P.E., P.S.
PORTAGE COUNTY ENGINEER