

**LEGEND**

- CITY ROADS
- STATE ROADS
- RAILROADS
- CORPORATION LINE

SCALE: 1" = 2000'



**GEAUGA COUNTY**

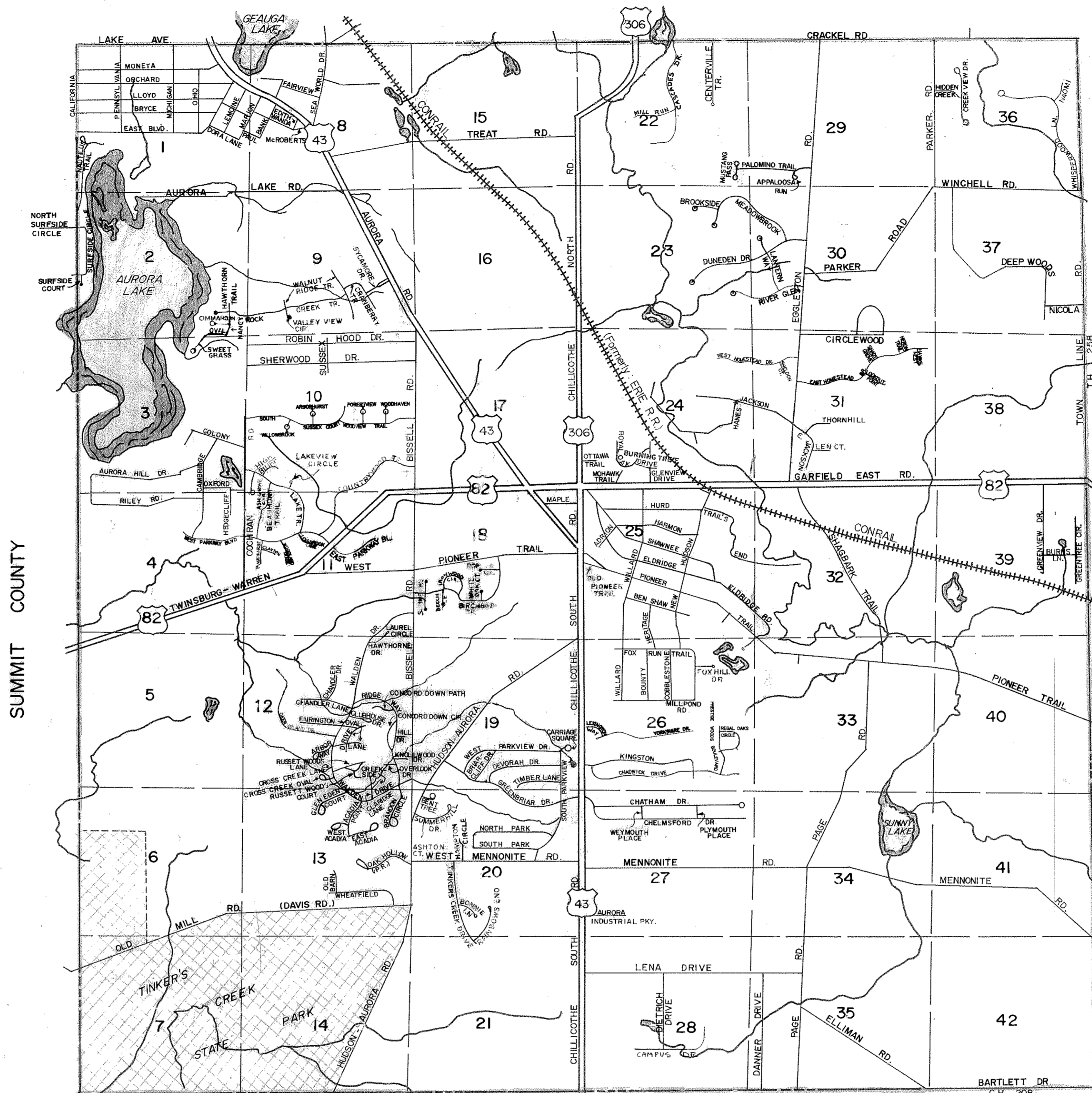

**Streetsboro City**

Mantua Township

**ROAD INDEX**

ROAD NAME	LOT	ROAD NAME	LOT
AURORA INDUSTRIAL PKY.	27	OAK HOLLOW (PR.)	13
ASH GROVE CIRCLE	10	OLD BARN	13
ACADIA POINT	13	OLD PIONEER TRAIL	25
ADRIAN	25	ORCHARD	15
APPALOOSA RUN	29	OVERLOOK DR.	15
ARBOR WAY	12	OXFORD	24
AURORA HILL DR.	3,4	OTTAWA TRAIL	24
AURORA LAKE	25,26,32,33	PARKVIEW	19
BURNS LN.	2	PENNSYLVANIA	1
BURNING TREE DR.	24-A	PIONEER TRAIL	25
BANK	2	PLYMOUTH PLACE	27
BARTLETT	4,25	PALOMINO TRAIL	29
BEN SHAW	25	PARKER	30
BENT TREE	20	PARKVIEW	19
BISSELL	10	PAUL	1
BOUNT	29	PENNSYLVANIA	1
BRANDON CIRCLE	19	PIONEER TRAIL	25
BRIARCLIFF	19	PLYMOUTH PLACE	27
BRUCE	10	PINE	18
BEAUMONT TRAIL	10	PINEHURST DRIVE	18
CALIFORNIA	3	RIDEWAY	12
CAMBRIDGE	3	RILEY	10
CARRIAGE	19	ROBIN HOOD DR.	10
CHANDLER	12	RUSSETT WOODS	12
CHATHAM DR.	27	SEA WORLD	8
CHELMSFORD DR.	27	SELDON CT.	31
CHILLICOTHE (SR 306)	15	SHAGEBARK TRAIL	32
CIRCLEWOOD	33	SHAWNEE	25
CLARIDGE LANE	10	SHAWNEE	10
CLUBHOUSE DR.	12	SOUTH PARK	20
COBBLESTONE	26	SOUTH PARKVIEW	19
COCHRAN	26	S.R. 43 (AURORA)	1
COLONY	12	S.R. 82 (GARFIELD)	24
CONCORD DOWN CIRCLE	12	S.R. 306 (CHILLICOTHE)	15
CONCORD DOWN PATH	22	SUSSEX	10
CRACKEL	22	SURFIDE COURT	10
CREEKSIDE	12	THORNHILL LANE	31
CROSSCREEK LANE	12	TIMBER LANE	19
CROSSCREEK OVAL	12	TOWNLINE	38
COURTNEY TR.	10	TRAILS END	26
CLEARBROOK LANE	11	TREAT	8
DANNER DRIVE	31	VALLEY VIEW CIR.	11
DEERWOODS	31	WALNUT RIDGE TRAIL	11,12-13
DEVORAH	19	WALDEN DR.	11
DIETRICH	28	WANDA	13
DORALANE	1	WEST ACADIA	13
EAST ACADIA	13	WEST PARKVIEW	19
EAST JACKSON	31	WEYMOUTH PLACE	27
EATH	31	WHEATFIELD	15
EGGLESTON	23	WILLARD	36
ELDRIDGE	23	WINCHELL	36
ELLIMAN	35	WHITE OAK CT.	18
EAST PARKWAY BLVD	11	WISPERWOOD LN.	4,11
FAIRINGTON	12	WEST PARKWAY BLVD	4,11
FAIRVIEW	10		
FOX RUN TRAIL	26		
FOX HILL DR.	26		
GARFIELD (SR 82)	24		
GLEN EDEN COURT	13		
GLENVIEW DR.	24		
GREENBRIAR	19		
GREENVIEW DR.	39		
HAWTHORNE DR.	12		
HANES	24		
HARMON	30		
HEDGECLIFF	25		
HERITAGE	25		
HILL DR.	12		
HUDSON-AURORA	12		
HURD	13		
HAMPTON CIRCLE	25		
HIGH BLUFF	15		
IRONWOOD CIR.	18		
JACKSON	24		
KNOLWOOD DR.	12		
LAUREL CIRCLE	10		
LAKE	11		
LEMOINE	31-A		
LEN COURT	28 & 35		
LENA DRIVE	28 & 35		
LLOYD	23		
MACROBERTS	8		
MAPLE	18		
MARION	27		
MENNONITE	27		
MICHIGAN	27		
MILL POND RD.	26		
MOHAWK TRAIL	24		
MONETA	21		
MUSTANG PASS	24		
NAOMI LANE	36		
NAUTILUS TRAIL	21		
NEW HUDSON	37		
NICOLA	37		
NORTH PARK	20		
N SURFIDE CIRCLE	2		
		AREAHURST CIRCLE	15
		CAMPUS DR.	22
		CLAYTON DR.	11
		CENTERVILLE TR.	22
		CHADWICK DR.	26
		CHARRON OVAL	2
		BURNING TREE DR.	24-A
		KINGSTON DR.	26
		SHADY GROVE	15
		SOUTH SUSSEX CT.	2
		SWEET GRASS CR.	2
		WILKINGSTON WAY	2,8
		LOOKOUT POINT	31
		HAWKS NEST	31
		MILL RUN	22

**AURORA CITY**

**ALLOTMENT INDEX**

AURORA INDUSTRIAL PARK III	28
ANDREW JACKSON ESTATES	24,31
ARROWOOD OF WALDEN	20
AURORA ACRES	10
AURORA ACRES HOMESITES	10
AURORA EXCHANGE CONDOMINIUM	18
AURORA HILL COLONY 1,2 & 3	3,4
AURORA LAND CO. SUBDIVISION 1	25
AURORA LAND CO. SUBDIVISION 2	25,26,32,33
AURORA SHORE'S SUBDIVISION 4	2-A
AURORA SHORE'S HAWTHORN SUBD.12	2
AURORA PINES VILLAS CONDOMINIUMS	19
AURORA CITY SCHOOLS B. OF EDUCATION	19
BLAIR PLACE CREEK CONDOMINIUMS	7
BRIARWOOD OF WALDEN	12
CAMPUS SQUARE SUBDIVISION	2,6
CENTERVILLE WOODS SUBDIVISION	22
CLUBSIDE MANOR CONDOMINIUM	16,24
EDGES TR. SOUTH OF WALDEN CONDO	20
EDGESTRA NORTH OF WALDEN CONDO	20
DUNEDEN SUB. PHASE 5	30-B
BARRINGTON SUBDIVISION NO. 1,2 & 3 & 4	8,9,15,16,17
BARTKO WILLIAM R. (RE SUBDIVISION)	16,17
BEECHWOOD ALLOTMENT	30,31
BENT TREE SUBDIVISION	20
BISSELL ESTATES	31
BONNIE VIEW ALLOTMENT & REPLAT	36
BRIDLE PATH ESTATES	22,29
BENT CREEK OF WALDEN	11
CHERRY PARK CONDOMINIUM	8-B
CHANDLER'S COVE OF WALDEN	12-B
CHATHAM ESTATES	27-A
CLARIDGES OF WALDEN	12-A
COMMERCIAL SUBDIVISION	18,13
CONCORD DOWNS OF WALDEN	18-A
C.S. GARDENS SUBDIVISION	12-B
DUNEDEN SUBDIVISION	3,23
DEEP WOODS SUBDIVISION	37
DEER ISLAND OF WALDEN	10-D
DEVON POND CONDOMINIUMS	10 & 10-D
FERN VALLEY	22
FAIRINGTON AT WALDEN	12
FORD AND MOWREY	24-A
FOUR SEASON TOWNE HOUSES	20-A
HARVEST ESTATES	36
GARDENS OF WALDEN, THE	12-E
GEAUGA LAKE ORCHARD CO.	1-B
DUNEDEN SUB. PHASE 4	1-C
	1-A

ALLOTMENT	LOT	PAGE	ALLOTMENT	LOT	PAGE
GREENVIEW ESTATES	39	39	SUMMERHILL SUBDIVISION I	20	20-B
GREENBRIAR ALLOTMENTS (1,2,3)	(19,20)	(19-A)	THORNHILL ESTATES I, II & III	31	31-A
HOMESTEAD (1) 37 (2) 31-5	(4,5,6,7)	(19,20)	TRAILS END SUBDIVISION	25,32	25-B
HEATHER WOODS SUBDIVISION	29,30	29-A	TARA AT BARRINGTON ESTATES CONDO	15	15
HAMPTON GLEN CONDOMINIUM	20	20	VILLA TRAIL CONDOMINIUMS	26,27	26-C
HAWTHORN SUBDIVISION	2,9,3	2,9,3	WELLINGTON SUBDIVISION	12,13	13-A
HIGHLAND ALLOTMENT	26	26-A	WEST AURORA SUBDIVISION	20,21	20-C
HIGHLAND FARMS SUBDIVISION	12	12-A, 26-B	WESTERN RESERVE LAND COMPANY	1,8	1-A THRU 1-H
HIGH POINT OF WALDEN	10	10-B			
LAKES OF AURORA SUBDIVISION NO 1	9,10	9,10			
LAKES OF AURORA PHASE 1-A, 2, 2-A, 3-A	10	10-B			
LAKEVIEW ALLOTMENT	8	8-A			
LANDINGS OF WALDEN PHASE I & II	11,12	12-C			
(LANDS END OF WALDEN (II)) PHASE III & IV	12-D	12-D			
LANGMYER ALLOTMENT	24	24-B			
LINCOLN FOREST	5	5			
LITTLE POINTE SUBDIVISION	19,20	20B			
LONGVIEW ACRES	20	20			
LAKES OF AURORA CONDOMINIUMS (II)	10,11 (10)	10-C, 11-A			
LAKES OF AURORA SUB. B-4 B-58-6	10,11	10-C, 11-A			
MAPLE GROVE ALLOTMENT	6	6			
MCCLEARY, LUELLA H.	30	30			
MEADOWS OF WALDEN, THE	37	37-C			
NICOLA SUBDIVISION	22	22			
PLAT OF MINOR SUBD. FOR BYRON W. HEATH	24	24			
OAKS OF AURORA	24	24			
OLD FARM SUBDIVISION	13	13			
RAVINES OF WALDEN	10	11-A			
RAVINES WEST OF WALDEN	10	11-E			
RESERVES OF AURORA CONDOMINIUMS	11	11-E			
RUSSETT WOODS OF WALDEN	12	12			
SENeca OF AIL ESTATES	24	24-A			
STONEWOOD ESTATES	24	24			
HIDDEN CREEK ESTATES	36	36			
HOLLY OAK LANE CONDOMINIUMS	10	10			
KENSINGTON COURT CONDO.	4	4			
PRESTIGE WOODS SUBDIVISION	26	26			
LENA DRIVE CONDOMINIUM	26	26			
HAWKIN SUBDIVISION	27	27-B			

**PORTAGE COUNTY OHIO**

MICHAEL A. MAROZZI P.E., P.S.  
PORTAGE COUNTY ENGINEER